

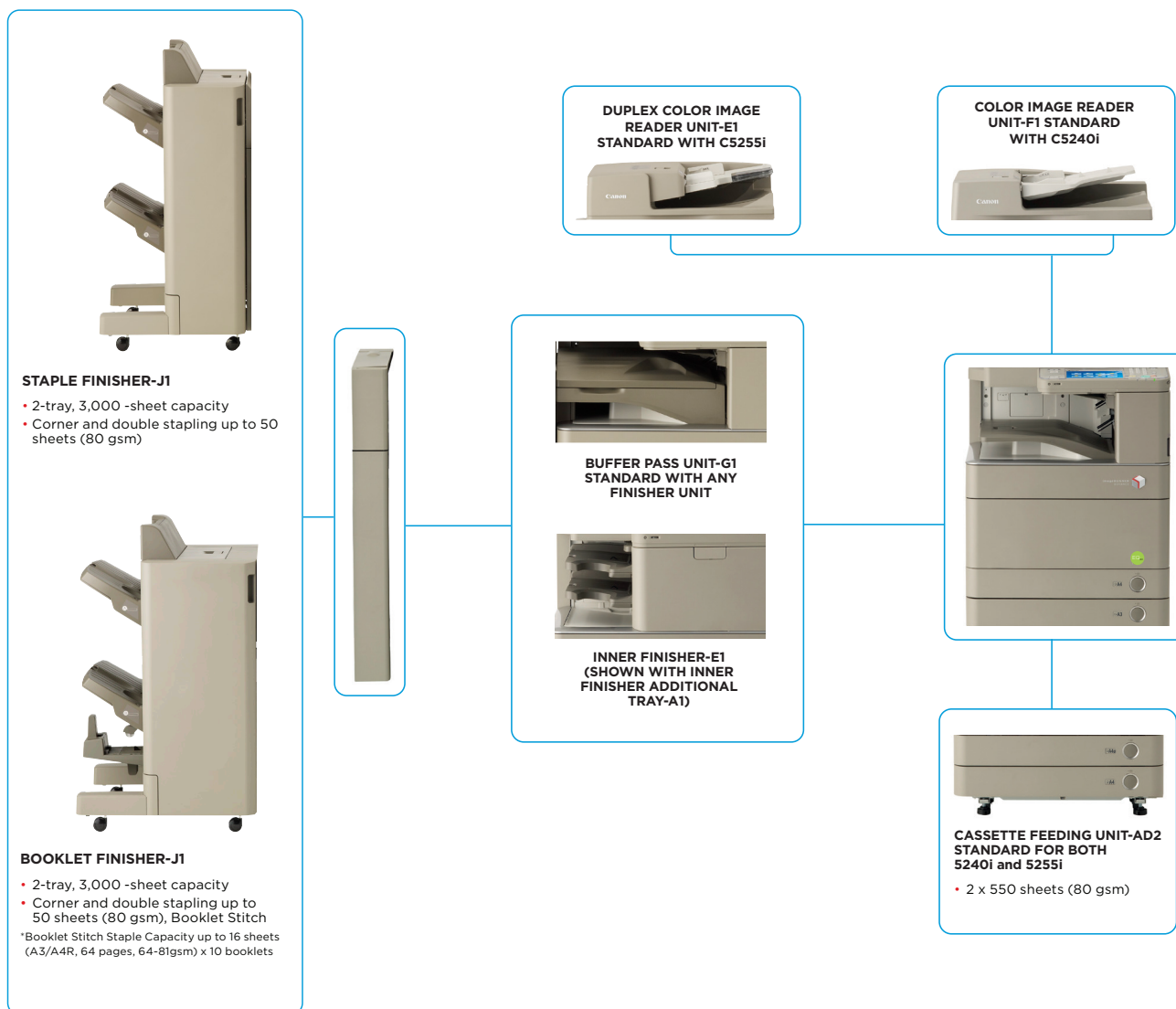

# IMPROVE OFFICE SUSTAINABILITY AND DOCUMENT SECURITY WITH A3 COLOUR DEVICES DESIGNED FOR BUSY OFFICES

## Main configuration options



# TECHNICAL SPECIFICATIONS

# imageRUNNER ADVANCE EQ80 C5200 Series

<b>Machine type</b>	Colour Laser Multifunctional (Reader/Printer separated)	<b>Operating System compatibility</b>	UFR II: Windows 10 (32-bit)/Windows 10 (64-bit) Windows 8.1 (32-bit)/Windows 8.1 (64-bit) Windows 7 (32-bit)/Windows 7 (64-bit)/Windows Server 2008 (32-bit)/Windows Server 2008 (64-bit)/Windows Server 2008 R2 (64-bit) Windows Server 2012 (64-bit)/Windows Server 2012 R2 (64-bit)/Windows Server 2016 (64-bit) Windows Server 2019 (64-bit) PCL: Windows 10 (32-bit)/Windows 10 (64-bit) Windows 8.1 (32-bit)/Windows 8.1 (64-bit) Windows 7 (32-bit)/Windows 7 (64-bit)/Windows Server 2008 (32-bit)/Windows Server 2008 (64-bit)/Windows Server 2008 R2 (64-bit) Windows Server 2012 (64-bit)/Windows Server 2012 R2 (64-bit)/Windows Server 2016 (64-bit) Windows Server 2019 (64-bit) PS: Windows 10 (32-bit)/Windows 10 (64-bit) Windows 8.1 (32-bit)/Windows 8.1 (64-bit) Windows 7 (32-bit)/Windows 7 (64-bit)/Windows Server 2008 (32-bit)/Windows Server 2008 (64-bit)/Windows Server 2008 R2 (64-bit) Windows Server 2012 (64-bit)/Windows Server 2012 R2 (64-bit)/Windows Server 2016 (64-bit) Windows Server 2019 (64-bit) PPD: Windows 10 (32-bit)/Windows 10 (64-bit) Windows 8.1 (32-bit)/Windows 8.1 (64-bit) Windows 7 (32-bit)/Windows 7 (64-bit) Please refer to <a href="http://software.canon-europe.com/">http://software.canon-europe.com/</a> for availability of print solutions for other operating systems and environments including AS/400, UNIX, Linux and Citrix. Some of these solutions are chargeable. SAP Device Types are available via the SAP Market Place.
<b>Available Core functions</b>	Print, Copy, Scan, Send and Optional Fax		
<b>PRINTER SPECIFICATIONS</b>			
<b>Print speed (BW/CL)</b>	iR-ADV C5240i: BW - 40ppm (A4), 20ppm (A3), 20ppm (A4R), 13ppm (A5R) CL - 35ppm (A4), 17.5ppm (A3), 17.5ppm (A4R), 4ppm (A5R) iR-ADV C5255i: BW - 55ppm (A4), 27.5ppm (A3), 27.5ppm (A4R), 13ppm (A5R) CL - 51ppm (A4), 25.5ppm (A3), 25.5ppm (A4R), 4ppm (A5R)		
<b>Printing method</b>	Colour Laser Beam Printing		
<b>Print resolution</b>	1200 dpi x 1200 dpi, 600 dpi x 600 dpi		
<b>Double sided printing</b>	Automatic (Standard)		
<b>Printing from memory media</b>	Supported memory media: USB memory key Supported file types for direct printing: JPEG, TIFF, PDF*, XPS* (*iR-ADV C5240i require PS PRINTER KIT-ARI for PDF or DIRECT PRINT KIT (for PDF/XPS)-H1 for PDF/XPS. XPS direct print from removable media is not available.)		
<b>Printing from mobiles or internet-connected devices and cloud-based services</b>	A range of software and MEAP-based solutions is available to provide printing from mobile devices or internet-connected devices and cloud-based services depending on your requirements. Please contact your sales representative for further information.		
<b>Paper input (Standard)</b>	4 x 550-sheet cassettes (80 gsm) and a 100-sheet multi-purpose tray		
<b>Maximum paper input capacity</b>	2300 sheets (80 gsm)	<b>COPY SPECIFICATIONS</b>	
<b>Paper output capacity</b>	Without Finisher: 250 sheets (80 gsm) With Inner Finisher: 500 sheets (with 1 tray); When second tray is installed:	<b>Copy speed</b>	Please, refer to the quoted print speeds
<b>Finishing capabilities</b>	Standard: Collate, Group With optional finishing units: Staple, Saddle Stitch	<b>First Copy Output Time (FCOT)</b>	iR-ADV C5240i EQ80: Approx 5.4 (BW)/8.1 (CL) sec or less iR-ADV C5255i EQ80: Approx 3.9 (BW)/6.0 (CL) sec or less
<b>Supported media types</b>	Cassettes: Thin, Plain, Recycled, Colour, Heavy, Pre-punched	<b>Copy resolution</b>	Reading: 600 dpi x 600 dpi Printing: 1200 dpi x 1200 dpi for characters/lines, 600 dpi x 600 dpi for graphics/images
<b>Supported media sizes</b>	Paper cassette 1: A4, A4R, A5, A5R, B5, Free size: 139.7 mm x 182 mm to 304.8 mm x 390 mm Paper cassettes 2, 3 and 4: A4, A4R, A3, SRA3, A5, A5R, B5, Free size: 139.7 mm x 182 mm to 304.8 mm x 457.2 mm Multi-purpose tray: A4, A4R, A3, SRA3, A5, A5R, B5, Free size: 99 mm x 139.7 mm to 320 mm x 457.2 mm Envelopes: No.10 (COM10), Monarch, ISO-C5, DL	<b>Multiple copy Reduction/Enlargement</b>	Up to 999 copies Zoom: 25-400 % in 1 % increments Fixed Zoom Ratio: 25 %, 50 %, 70 %, 100 %, 141 %, 200 %, 400 %
<b>Supported media weights</b>	Cassettes: 52 to 220 gsm, Multi-purpose tray: 52 to 256 gsm Duplex: 52 to 220 gsm	<b>Optional/Standard Memory</b>	Optional 2 GB
<b>Page Description Language(s)</b>	UFR II (Standard) PCL5e/6 Adobe PostScript Level 3 (Only for C5255i EQ80)	<b>Fonts</b>	138 Adobe PS fonts installed, double byte font support
<b>Fonts</b>	PCL fonts: 93 Roman, 10 Bitmap, 2 OCR fonts, Andalé Mono PS fonts: 136 Roman fonts	<b>Network protocols</b>	TCP/IP, AppleTalk, Bonjour, SNMP, IPP, FTP, SMB, NTP, IPv6
		<b>SCAN SPECIFICATIONS</b>	
		<b>Supported media size/s</b>	C5240i: A3, A4, A4R, A5, A5R, B5, B5R, B6; Free sizes (W x L): Min. 139.7 mm x 128 mm, Max. 297 mm x 431.8 mm C5255i: A3, A4, A4R, A5, A5R, B5, B5R, B6; Free sizes (W x L): Min. 139.7 mm x 128 mm, Max. 297 mm x 431.8 mm
		<b>Supported media weight/s</b>	C5240i (BW/CL): Single-sided scanning: 42 to 128 gsm/64 to 128 gsm; Double-sided scanning: 50 to 128 gsm/64 to 128 gsm; C5255i (BW/CL): Single-sided scanning: 42 to 157gsm/64 to 157 gsm; Double-sided scanning: 50 to 157 gsm/64 to 157 gsm
		<b>Scan resolution</b>	100 dpi, 150 dpi, 200 x 100 dpi, 200 dpi, 300 dpi, 200 x 400 dpi, 400 dpi, 600 dpi
		<b>Double sided scanning</b>	2-sided to 2-sided (Automatic)
		<b>Scan speed (A4, 300 dpi)</b>	C5240i: Single-sided: 51/51 ipm (BW/CL); Double-sided: 19.6/19.6 ipm (BW/CL) C5255i: Single-sided: 75/75 ipm (BW/CL); Double-sided: 120/120 ipm (BW/CL)

# TECHNICAL SPECIFICATIONS

# imageRUNNER ADVANCE EQ80 C5200 Series

<b>Scan methods</b>	Push Scan: Send functionality available on all models Pull Scan: TWAIN/WIA Pull scanning available on all models Scan to USB Memory Key: Available on all models Scan to Mobiles, internet-connected devices and cloud-based services: A range of solutions is available to provide scanning to mobile devices, internet-connected devices and cloud-based services depending on your requirements. Please contact your sales representative for further information.	<b>Control panel</b>	21.3 cm (8.4 inch) TFT SVGA LED Backlight Colour Touchscreen
		<b>Dimensions (W x D x H)</b>	C5240i: 620 mm x 712 mm x 1182 mm C5255i: 620 mm x 715 mm x 1201 mm
		<b>Installation space (W x D)</b>	850 mm x 1196 mm (iR-ADV C5255i EQ80 + Multi-purpose tray + Cassette drawers open) 850 mm x 1164 mm (iR-ADV C5240i EQ80 + Multi-purpose tray + Cassette drawers open)
		<b>Weight</b>	(inc. Cassette Feeding Unit) C5240i: 172kg C5255i: 177kg
<b>Pull scan specifications</b>	Windows 10 (32-bit)/Windows 10 (64-bit) Windows 8.1 (32-bit)/Windows 8.1 (64-bit) Windows 7 (32-bit)/Windows 7 (64-bit)/Windows Server 2008 (32-bit)/Windows Server 2008 (64-bit)/Windows Server 2008 R2 (64-bit) Windows Server 2012 (64-bit)/Windows Server 2012 R2 (64-bit)/Windows Server 2016 (64-bit) Windows Server 2019 (64-bit)	<b>Operating environment</b>	Temperature: 10 to 30°C (50 to 86°F) Humidity: 20 to 80 % RH (no condensation)
		<b>Power Source</b>	220-240 V (±10 %), 50/60 Hz (±2 Hz), 4.3-5.6 Amp
		<b>Power Consumption</b>	Maximum: Approx. 1.8 KW (iR-ADV C5255i EQ80), 1.5 KW (iR-ADV C5240i EQ80) Standby: Approx. 110 W Energy Saver Mode: Approx. 60 W Sleep mode: Approx. 0.8 W or less* TEC rating (As per Energy Star v2.0) 2.9kwh (iR-ADV C5255i EQ80), 2.20kwh (iR-ADV C5240i EQ80) *1 watt sleep mode may not be possible in all circumstances, please refer to the User Guide for more information.
<b>SEND SPECIFICATIONS</b>			
<b>Send resolution</b>	100 dpi, 150 dpi, 200 x 100 dpi, 200 dpi, 300 dpi, 200 x 400 dpi, 400 dpi, 600 dpi	<b>Noise Levels</b>	Sound Pressure* Active: C5255i EQ80: 53dB, C5240i EQ80: 51dB Standby: C5255i EQ80: 31 dB, C5240i EQ80: 25 dB *Declared noise emission in accordance with ISO 7779
<b>Destinations</b>	E-Mail/Internet FAX (SMTP), PC (SMB, FTP), WebDAV.	<b>Software and printer management</b>	iW Management Console for centralised management of the device (Consumables and error monitoring and alerts, address book, configuration and firmware updating, MEAP applications distribution, meter capture, driver and resource management); Compatible with eMaintenance services via embedded RDS (Enables meter capture, automatic consumables management and remote diagnostics); Content Delivery System (Remote distribution of firmware, iR options and MEAP applications); Remote User Interface (RUI); Network ScanGear; NetSpot Device Installer; MEAP (Multifunctional Embedded Application Platform); MEAP Web
<b>Address Book/Speed dials</b>	LDAP (1000)/Local (Max. 500)		
<b>File formats</b>	TIFF, JPEG, PDF, XPS, High compression PDF/XPS, PDF/A-1b, Searchable PDF/XPS, Office Open XML (PowerPoint, Word)	<b>Security Features</b>	Standard: IP/Mac Address Filtering, IPSEC, SNMP V3.0, IEEE 802.1X, Trusted Platform Module (TPM), Secure Print, HDD Password Lock, HDD Erase, Universal Login Manager, Department ID, SSO-H, Mailbox, Access Management System TLS 1.2 Optional: Encrypted Secure Print and Secure Watermarks, Encrypted PDF, User and Device signatures. The following items require <a href="#">uniFLOW Online</a> : Scan to Cloud, Print from Cloud, My Print Anywhere
<b>Optional Universal Send Feature Sets</b>	Universal Send Advanced Feature Set-E1: Create outline PDF (Trace and Smooth) and Adobe Reader Extensions PDF UNIVERSAL SEND SECURITY FEATURE SET-D1: Send encrypted PDF, and add digital device signature to PDF/XPS files.		
<b>FAX SPECIFICATIONS</b>			
<b>Optional/Standard</b>	Optional on all models (with Super G3 Fax BOARD-AE1)		
<b>Modem speed</b>	Super G3 33.6kbps (3 sec/page)*		
<b>Fax resolution</b>	Standard: 200 x 100 dpi Fine: 200 x 200 dpi Super fine: 200 x 400 dpi Ultra fine: 400 x 400 dpi		
<b>FAX memory</b>	Up to 6000 pages* *Based on ITU-T Standard Chart No. 1		
<b>Speed dials</b>	Max. 200		
<b>Group dials/destinations</b>	Max. 199 dials		
<b>Sequential broadcast</b>	Max. 256 addresses from the address book plus new 256 destinations		
<b>Memory backup</b>	3 hours		
<b>Receive</b>	Print Received Fax Documents, Store in Memory RX Inbox, Fax Forwarding, Forwarding Settings, Forward Without Conditions, Confidential Fax Inbox, Forwarding Done Notice.		
<b>Send</b>	Original Type Selection, Two-sided Original, Book to Two Pages, Different Size Originals, Density for Scanning, Sharpness, Copy Ratio, Erase Frame, Job Build, Specifying the Sender's Name (when sending fax), Direct Send, Memory Send, Delayed Send, Preview, Finished Stamp, Job Done Notice, Send with a subaddress.	<b>CONSUMABLES</b>	
		<b>Toner Cartridge/s</b>	C-EXV 28 TONER BK/CY/MG/YL (yield 44000/38000/38000/38000 pages (Based on 6% coverage) (for iR-ADV C5255i EQ80) C-EXV 29 TONER BK/CY/MG/YL (yield 36000/27000/27000/27000 pages (Based on 6% coverage) (for iR-ADV C5240i EQ80)
<b>GENERAL SPECIFICATIONS</b>		<b>SPECIFICATIONS FOR OPTIONS</b>	
<b>Warm-up Time</b>	Approx. 31 sec from power ON (Normal mode), 7 sec from power ON (Quick Start mode)	<b>Staple Finisher 1</b>	INNER FINISHER-E1 (compact inner finisher) Number of Trays: 1 (additional tray available as option) Standard Tray Capacity: 500 sheets (A4/A5/A5R), 200 sheets (SRA3, A3, A4R) (80 gsm) Capacity with optional tray: Upper tray: 100 sheets (all sizes), lower tray: 200 sheets Paper Weight: 52 to 256 gsm Staple Position: Corner, Double Staple Capacity: A4: 50 sheets; A3/A4R: 30 sheets Dimensions (W x D x H): 865 mm x 540 mm x 234 mm Weight: Approx. 12 kg, with additional tray: 13 kg
<b>Recovery from sleep mode</b>	18 sec (iR-ADV V5240i EQ80), 15 sec (iR-ADV C5255i EQ80)		
<b>Interface type</b>	USB 2.0 Hi-Speed, Ethernet: 1000BaseT/100Base-TX/10Base-T, 1 x USB Host (2.0)		
<b>Network protocols</b>	TCP/IP* (LPD/Port 9100/WSD/IPP/IPPS/SMB/FTP), IPX/SPX (NDS, Bindery), AppleTalk *IPv4/IPv6 support		
<b>Processor Speed</b>	1.8 Ghz		
<b>Memory</b>	2.5 GB		
<b>Hard Disk Drive</b>	Standard 320 GB Hard Disk Drive (usable space 160 GB)		

# imageRUNNER ADVANCE EQ80 C5200 Series

## Staple Finisher 2

STAPLE FINISHER-J1 (External) (BUFFER PASS UNIT-G1 is included as standard)  
 Number of Trays: 2  
 Tray A (Upper) Capacity: A4/A5R 1300 sheets, A3/A4R 650 sheets  
 Tray B (Lower) Capacity: A4/A5R 1700 sheets, A3/A4R 650 sheets  
 Paper Weight: 52 to 256 gsm  
 Staple Position: Corner, Double  
 Staple Capacity: A4: 50 sheets; A3/A4R: 30 sheets.  
 Dimensions (W x D x H): 559 mm x 646 mm x 1097 mm  
 (when the extension tray is not extended)  
 Weight: Approx. 46 kg

## Booklet Finisher

BOOKLET FINISHER-J1 (External) (BUFFER PASS UNIT-G1 is included as standard)  
 Number of Trays: 2  
 Tray A (Upper) Capacity: A4/A5R 1300 sheets, A3/A4R 650 sheets  
 Tray B (Lower) Capacity: A4/A5R 1700 sheets, A3/A4R 650 sheets  
 Paper Weight: 52 to 256 gsm  
 Staple Position: Corner, Double, Booklet Stitch  
 Staple Capacity: A4: 50 sheets; A3/A4R: 30 sheets  
 Booklet Stitch paper size: A3, A4R  
 Booklet Stitch Staple Capacity: 16 sheets (64 pages, 64-81 gsm) x 10 booklets  
 Dimensions (W x D x H): 671 mm x 646 mm x 1097 mm (when the extension tray is not extended)  
 Weight: Approx. 75 kg

## Booklet Trimmer

Not Available

## ADDITIONAL OPTIONS

### Hardware accessories 1

INNER FINISHER ADDITIONAL TRAY-A1: Adds a second output tray for the INNER FINISHER-E1.

### Hardware accessories 2

### Print controller accessories

### System accessories

### Device security accessories

### Document security accessories

### Accessibility accessories

### Other options

Copy Tray-J2: Provides a simple tray for basic output needs. Output capacity is 100 sheets (A4).

Various card readers available e.g. MiCard Plus. Please contact local Canon Office for more details.

BARCODE PRINTING KIT-D1: Enables barcode printing via jet caps technology.

REMOTE FAX KIT-A1: Enables the device to send and receive fax from another device connected with a fax board.

USB DEVICE PORT-E4: Adds two additional USB Ports to use with uniFLOW or 3rd party card readers

WEB ACCESS SOFTWARE-H1: Provide access to websites and other web-based Online content.

HDD DATA ENCRYPTION AND MIRRORING KIT-C1: Provides encryption and mirroring of both temporary and permanent data. Encryption enables copied or scanned images to be encrypted BEFORE they are saved on the device's hard drive. The pack includes the Common Criteria level EAL3 certified Canon MFP security kit 2.01. Mirroring copies all data in real time, providing a highly reliable back-up.

SECURE WATERMARK-B1: Deters duplication of sensitive documents by embedding hidden watermarks that become visible when copied.

ENCRYPTED PRINTING SOFTWARE-D1: Encrypts the print job in transit to the device and requires a password at the printer before documents can be printed.

ADF ACCESS HANDLE-A1: Attaches to the document feeder, making access easier for seated users.

REMOTE OPERATORS SOFTWARE KIT-B1: Allows use of the device control panel screens from remote computers.

STAMP INK CARTRIDGE-C1

STAPLE CARTRIDGE-D3: (R) GP for Booklet Finisher-J1.

STAPLE CARTRIDGE-J1: GP for Inner Finisher-E1 and Staple Finisher J1.

## Disclaimers

Specifications are subject to change, please check with your local Canon Office for latest updates.

## Software & Solutions



Canon Ireland  
 3006 Lake Drive  
 Citywest, Saggart  
 Co. Dublin, Ireland  
 Telephone No: 01 2052400  
 Facsimile No: 01 2052525  
 canon.ie

Canon (UK) Ltd  
 5 The Square  
 Stockley Park  
 Uxbridge  
 UB11 1ET  
 Tel: 01895 648 000  
 www.canon.co.uk

Canon Inc.  
 canon.com  
**Canon Europe**  
 canon-europe.com  
 English edition  
 © Canon Europa N.V., 2020